



**EXECUTIVE STYLE
PROPERTY**



8A/13-15 Langlee Avenue Bondi NSW

2 🛏 2 🚿 1 🚗

Wednesday 28th June 1.45pm - 2pm

Thursday 29th June 1.45pm - 2pm

Saturday 1st July 1.45pm - 2pm

View : <https://www.executivestyleproperty.com.au/lease/nsw/eastern-suburbs/bondi/residential/townhouse/7305992>

Luxurious dual level furnished townhouse overlooking lush greenery to the ocean.

Wide open entertainer's terrace and garden creates a light, fresh and inviting space.

Waverley Park, Charing Cross village, Bondi Road shopping and Tamarama & Bronte beaches all a short walk.

- + Air conditioning
- + Whole floor living area, excellent in/outdoor entertaining
- + Generous private courtyard garden bathed in sun



Tyler Leighton
0419 737 516

<https://www.executivestyleproperty.com.au>

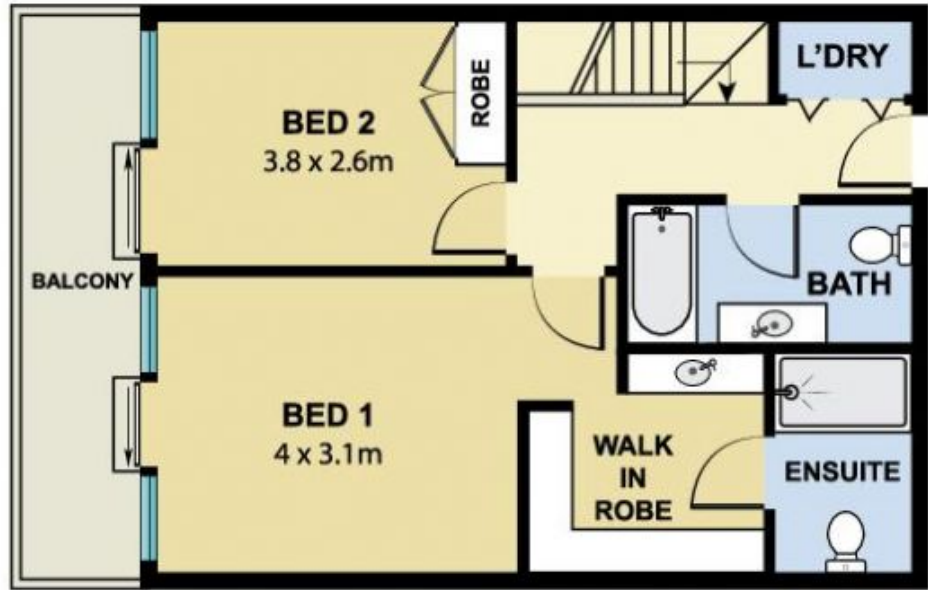

First Floor

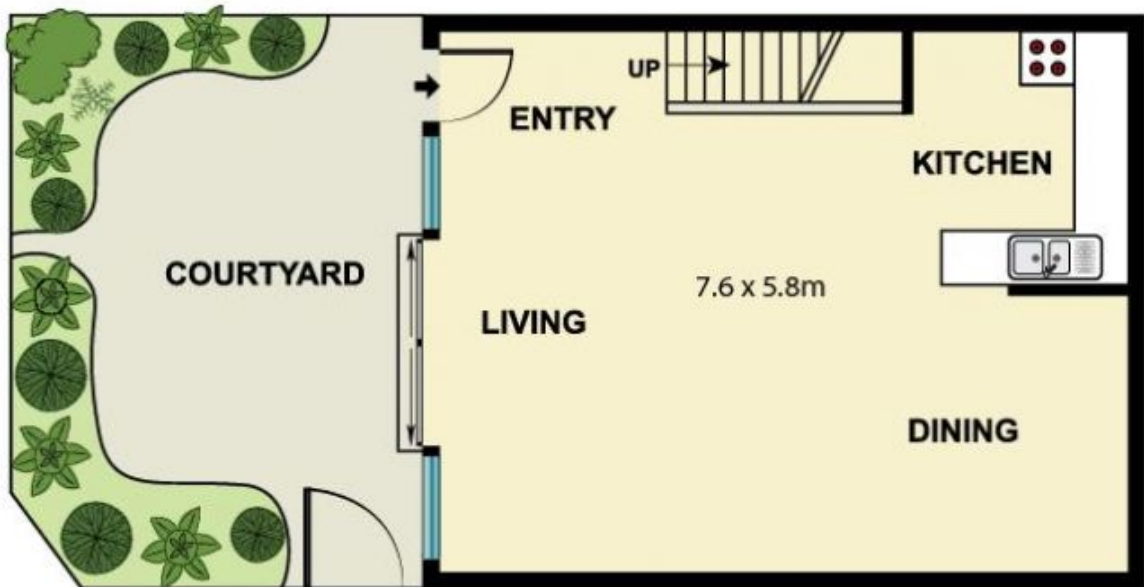

Ground Floor

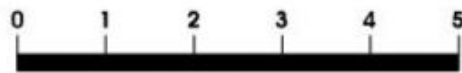

SCALE (METRES)

10/13-15 Langlee Avenue, Waverley

Scale in metres. Indicative only. Dimensions are approximate. All information contained here in is gathered from sources we believe to be reliable. However we cannot guarantee its accuracy and interested persons should rely on their own enquiries.